

D. D. A.

DWARKA PROJECT

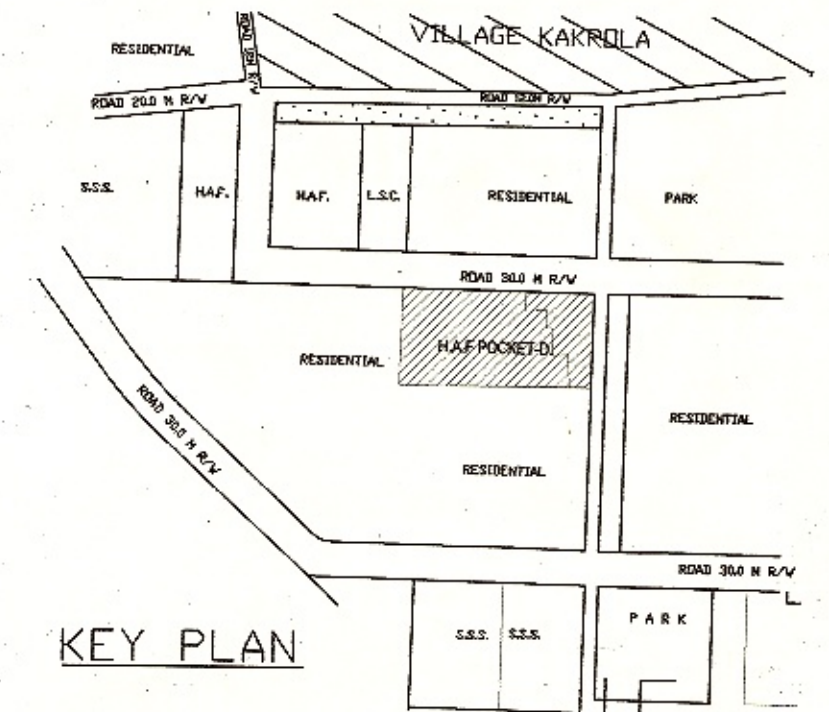

AREA STATEMENT :-

PLOT NO.	AREA(SQ.M.)	FACILITY
①	2002	MULTI PURPOSE COMMUNITY HALL
②	1076	CONVENIENCE SHOPPING CENTRE WITH MILK & VEGETABLE BOOTH
③	80	ESS
④	411	RELIGIOUS BUILDING-I
⑤	415	RELIGIOUS BUILDING-II
⑥	635	UTILITY (EXIST. PUMP HOUSE)
⑦	2000	PRIMARY SCHOOL
⑧	1005	MATERNITY HOME /NURSING
⑨	1000	HOME / POLYCLINIC
⑩	1214	DISPENSARY
	1876	CIRCULATION
SUB TOTAL	11714	
	3797	AREA NOT IN POSSESSION OF DDA
GRAND TOTAL	15511	





NOTES:-

1. THE DEVELOPMENT CONTROL NORMS & SET BACKS WILL BE AS PER MASTER PLAN.
2. THE LAY OUT PLAN IS BASED ON TOTAL STATION SURVEY PROVIDED BY EX. ENGR. WD -6 VIDE LETTER NO.F.1(8/AE/P)/WD-6/DDA /962 DATED 17.09.2011

FILE NO. F.4(16)/93/PLG./DWK/PL.III

LAYOUT PLAN OF HAF POCKET-D, NEAR VILLAGE KAKROLA, SECTOR-16B DWARKA.

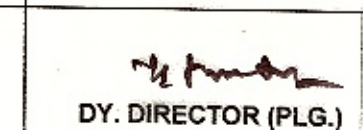
SCALE :1:50 DRG. NO.DDA/DWK/HAF/PKT.-D/SEC.16-B/SEPT.11/ 82

 PLG. ASST.
 ASST. DIR. (PLG.)
 DY. DIRECTOR (PLG.)
 DIRECTOR (PLG.)

DELHI DEVELOPMENT AUTHORITY

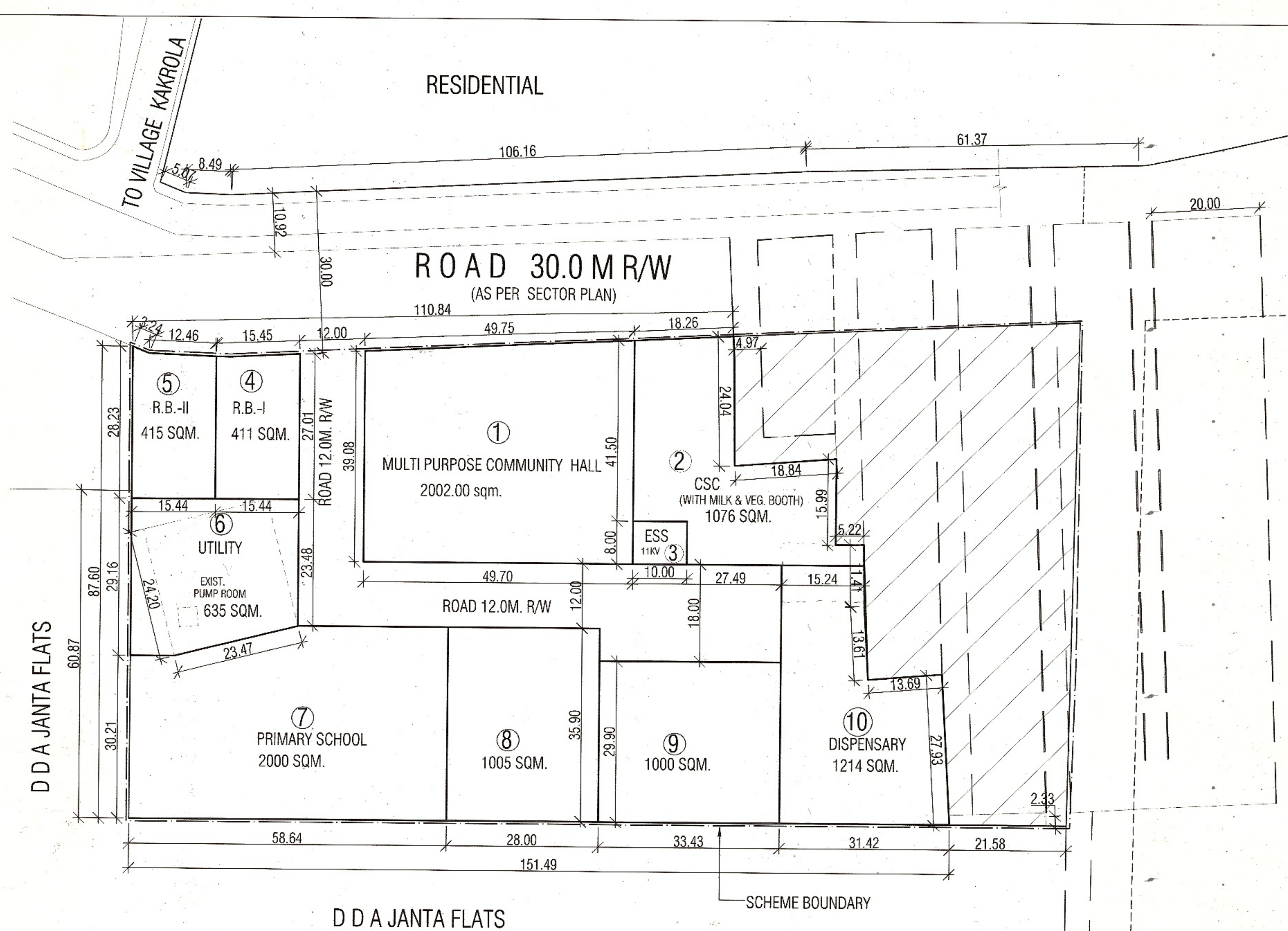

APPROVED IN THE 301st SCREENING COMMITTEE MEETING HELD ON 19.10.2011 VIDE ITEM NO. 88:2011 WITH OBSERVATION THAT THE PLOTS OF CSC & ESS BOTH TOGETHER BE SWAPPED WITH THE PLOT OF MULTIPURPOSE COMMUNITY HALL

ROAD 12 MR/W
(AS PER SECTOR PLAN)

12.00